

Precision Devices, Inc.

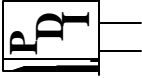

8840 N. Greenview Dr.
Middleton, WI 53562
Phone: 608-831-4445
1-800-274-XTAL
Fax: 608-831-3343

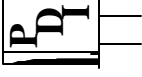

Visit our web site at www.pdixtal.com

Sales Information sales@pdixtal.com

Electrical Specifications

1. Center Frequency: 48.000000MHz \pm 1Hz
2. Output Wave Shape: Sinewave
3. Input Voltage: +15Vdc \pm 3% Max.
4. Input Power: Less than 1.125Watts
5. Load Impedance: 50 Ohms Nominal with a load VSWR of 2.0:1 of any phase
6. Output Level: Shall be +9dBm \pm 1.5dBm into a 50 Ohm load at the following temperatures;
-54°C, -40°C, -20°C +25°C, +70°C, +85°C, +105°C
7. Frequency Stability: after 1/2 hour of operation, the output frequency shall not change by more than the following limits from the reference frequency:

Temperature Range

- \pm 40°C to +85°C
- 20°C to +70°C
- 54°C to -40°C
- +85°C to +105°C

Frequency Change In 24hr Period

- \pm 240Hz Max.
- \pm 96Hz Max.
- \pm 5KHz Max.
- \pm 5KHz Max.

8. Aging: 96Hz per year Max.
9. Harmonic Related Outputs: The harmonic content of the output shall be at least 40dB below the rated output.
10. Non-Harmonic Related Outputs: The non-harmonic content of the output shall be at least 60dB below the rated output.
11. Frequency Adjustment: Adjustment range shall be sufficient for 5 years aging.
12. Operating Temperature Range: -54°C to +105°C
13. Storage Temperature Range: -62°C to +125°C
14. For all other specifications and testing requirements please refer to Hazeltine Corporation drawing number 331706.

The information contained in this drawing is the sole property of Precision Devices Inc. Any reproduction in part or as a whole without the written permission of Precision Devices Inc. is prohibited.

REV.	DATE	PAGE	DESCRIPTION	Auth.	ECN	FOR PRELIMINARY USE ONLY Specifications subject to change without notice.			
						Temp. Compensated Crystal Oscillator		17719	
						PART NUMBER SPCL48000XWSSXX			
						DATE	SCALE	ECN.	REV.
						2/3/05	N.T.S.	N/A	N/A
						SIZE	CAGE	Page 1 of 2	
						A	OS4G1		

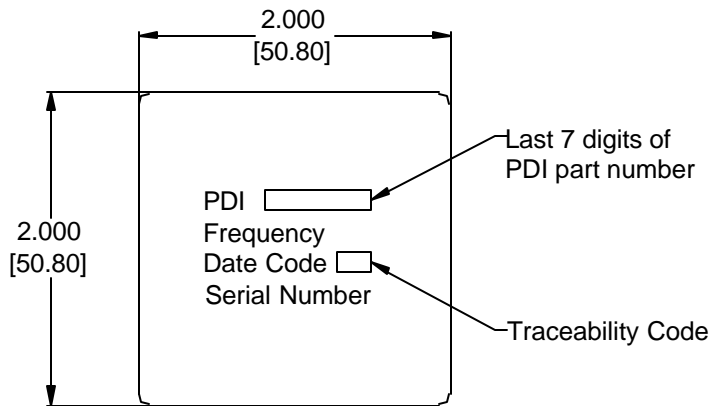
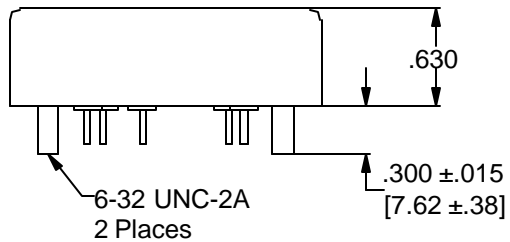
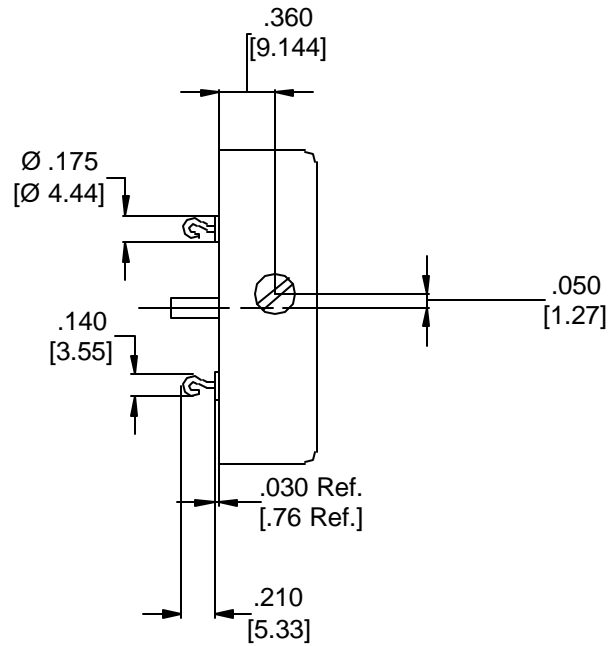
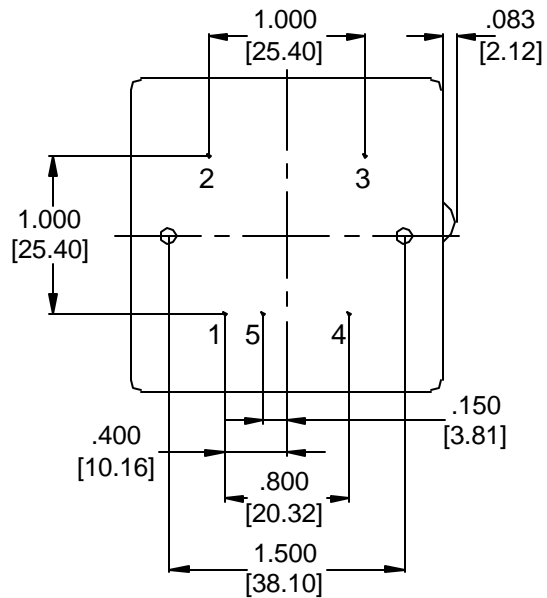

PIN CONNECTION

- 1 | RF Output
- 2 | B+
- 3 | B- and common
- 4 | Case
- 5 | RF Return

Precision Devices Inc.

8840 N. Greenview Dr.
Middleton WI 53562
608-831-4445
1-800-274-XTAL

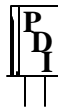

Manufacturer of Quartz Crystal Products

DECIMAL XX=±.020 XXX=±.008	DWG FILE 17719	PART NUMBER SPCL48000XWSSXX	
METRIC XX=±.50 XXX=±.20	SCALE N.T.S.	FREQUENCY 48.000000MHz	DRAWN BY J. Bender
ANGULAR XX=±2°	REV. LEVEL N/A	ECN NO. N/A	DATE 2/3/05
		CAGE CODE OS4G1	Page 2 of 2