

RECEIVER

ETHER

Type **SD-1**
 DC Resistance (Ω) 135 \pm 15
 AC Impedance (Ω) 150 \pm 30
 Sensitivity (dB) 115 \pm 2 at 1mW
 Frequency Range (Hz) 200-4000
 THD $<$ 3%
 Operating Temperature ($^{\circ}$ C) -20-+55
 Weight (g) 39

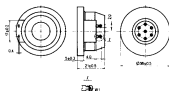
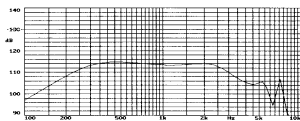

Type **SD-2**
 DC Resistance (Ω) 135 \pm 10%
 AC Impedance (Ω) 150 \pm 20%
 Sensitivity (dB) 112 \pm 2 at 1mW
 Frequency Range (Hz) 300-3400
 THD $<$ 3%
 Operating Temperature ($^{\circ}$ C) -10-+40
 Weight (g) 18

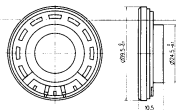
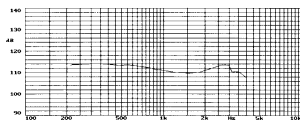

Type **SD-3**
 DC Resistance (Ω) 30 \pm 10%
 AC Impedance (Ω) 32 \pm 20%
 Sensitivity (dB) 116 \pm 3/-1 at 1mW
 Frequency Range (Hz) 100-5000
 THD $<$ 2%
 Operating Temperature ($^{\circ}$ C) -20-+40
 Weight (g) 1

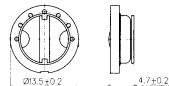
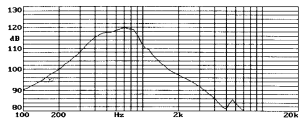

Type **SD-4**
 DC Resistance (Ω) 14.5 \pm 10%
 AC Impedance (Ω) 16 \pm 20%
 Sensitivity (dB) 113 \pm 4 at 1mW
 Frequency Range (Hz) 200-4000
 THD $<$ 2%
 Operating Temperature ($^{\circ}$ C) -20-+40
 Weight (g) 2

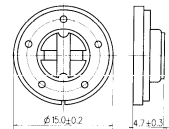
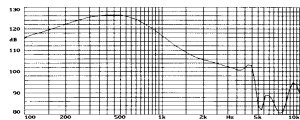

RECEIVER



Type **SD-5**
 DC Resistance (Ω) 135 \pm 10%
 AC Impedance (Ω) 150 \pm 20%
 Sensitivity (dB) 108 \pm 3 at 60mV
 Frequency Range (Hz) 200-5000
 THD \leq 2%
 Operating Temperature ($^{\circ}$ C) -10 \rightarrow +40
 Weight (g) 1

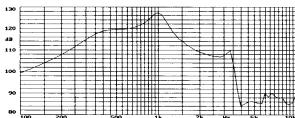

Type **SD-6**
 DC Resistance (Ω) 90 \pm 10%
 AC Impedance (Ω) 100 \pm 20%
 Sensitivity (dB) 105 \pm 3 at 60mV
 Frequency Range (Hz) 50-5000
 THD \leq 2%
 Operating Temperature ($^{\circ}$ C) -10 \rightarrow +40
 Weight (g) 6

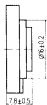
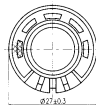
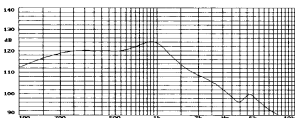

Type **SD-7**
 DC Resistance (Ω) 30 \pm 10%
 AC Impedance (Ω) 32 \pm 20%
 Sensitivity (dB) 102 \pm 2 at 1mW
 Frequency Range (Hz) 200-4000
 Operating Temperature ($^{\circ}$ C) \leq 3%
 Weight (g) -20 \rightarrow +40
 2.2

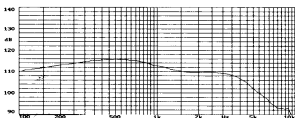

Type **SD-8**
 DC Resistance (Ω) 135 \pm 10%
 AC Impedance (Ω) 150 \pm 20%
 Sensitivity (dB) 96 \pm 3 at 100mV
 Frequency Range (Hz) 300-3000
 THD \leq 2%
 Operating Temperature ($^{\circ}$ C) -40 \rightarrow +60
 Weight (g) 7

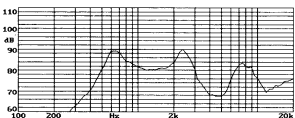

RECEIVER

Type **SD-9**
 DC Resistance (Ω) $135 \pm 10\%$
 AC Impedance (Ω) $150 \pm 20\%$
 Sensitivity (dB) 88 ± 3 at 60mV
 Frequency Range (Hz) 300-3000
 Operating Temperature ($^{\circ}\text{C}$) $< 3\%$
 Weight (g) -20 to $+55$
 2.5

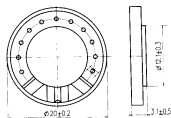
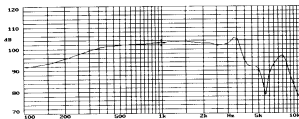

Type **SD-10**
 DC Resistance (Ω) $135 \pm 10\%$
 AC Impedance (Ω) $150 \pm 20\%$
 Sensitivity (dB) 91 ± 2 at 60mV
 Frequency Range (Hz) 300-3400
 THD $< 2\%$
 Operating Temperature ($^{\circ}\text{C}$) -25 to $+65$
 Weight (g) 5

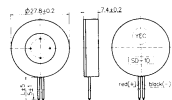
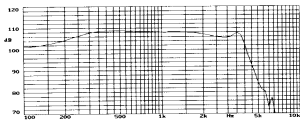

Type **SD-13**
 DC Resistance (Ω) $30 \pm 10\%$ $184 \pm 10\%$
 AC Impedance (Ω) $32 \pm 20\%$ $220 \pm 20\%$
 Sensitivity (dB) 100 ± 3 at 1mW
 Frequency Range (Hz) 300-3400
 THD $< 3\%$
 Operating Temperature ($^{\circ}\text{C}$) -10 to $+40$
 Weight (g) 5

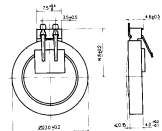
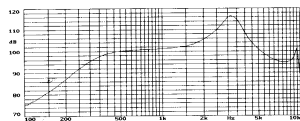

Type **SD-14**
 DC Resistance (Ω) $135 \pm 10\%$
 AC Impedance (Ω) $150 \pm 25\%$
 Sensitivity (dB) 110 ± 3 at 1mW
 Frequency Range (Hz) 200-5000
 THD $< 3\%$
 Operating Temperature ($^{\circ}\text{C}$) -20 to $+50$
 Weight (g) 22

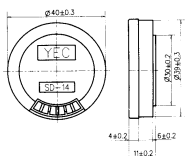
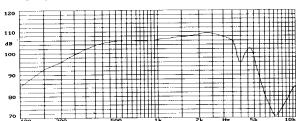

RECEIVER

Type **SD-15**
 DC Resistance (Ω) $135 \pm 10\%$
 AC Impedance (Ω) $150 \pm 20\%$
 Sensitivity (dB) 116 ± 2 at 1mW
 Frequency Range (Hz) 250-4000
 THD $< 5\%$
 Operating Temperature ($^{\circ}\text{C}$) -20~+50
 Weight (g) 67

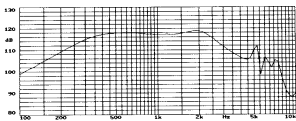
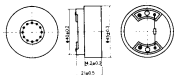

Type **SD-16**
 DC Resistance (Ω) 140 ± 30
 AC Impedance (Ω) $150 \pm 15\%$
 Sensitivity (dB) 116 ± 3 at 1Vrms
 Frequency Range (Hz) 300-3400
 THD $< 2\%$
 Operating Temperature ($^{\circ}\text{C}$) -40~+470
 Weight (g) 1.5

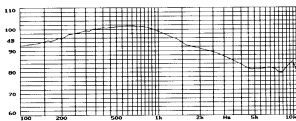
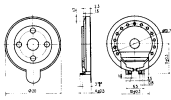

Type **SD-17**
 DC Resistance (Ω) $30 \pm 10\%$
 AC Impedance (Ω) $32 \pm 15\%$
 Sensitivity (dB) 86 ± 2 at 60mV
 Frequency Range (Hz) 300-3400
 THD $< 3\%$
 Operating Temperature ($^{\circ}\text{C}$) -20~+40
 Weight (g) 2

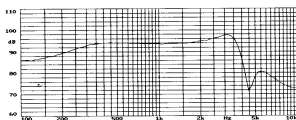
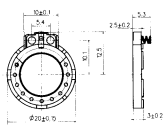

Type **SD-18**
 DC Resistance (Ω) 140 ± 30
 AC Impedance (Ω) 150 ± 30
 Sensitivity (dB) 86 ± 3 at 60mV
 Frequency Range (Hz) 300-3400
 THD $< 10\%$
 Operating Temperature ($^{\circ}\text{C}$) -40~+85
 Weight (g) 7

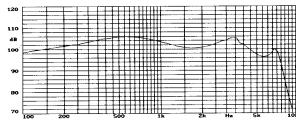
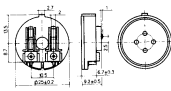

RECEIVER



Type **SD-19**
 DC Resistance (Ω) $135 \pm 10\%$
 AC Impedance (Ω) $150 \pm 20\%$
 Sensitivity (dB) 113 ± 3 at 1mW
 Frequency Range (Hz) 250-4000
 THD $< 5\%$
 Operating Temperature ($^{\circ}\text{C}$) -20-+55
 Weight (g) 32

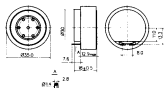
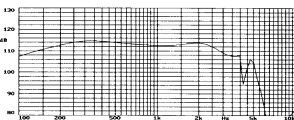

Type **SD-20**
 DC Resistance (Ω) 135 ± 15
 AC Impedance (Ω) 150 ± 30
 Sensitivity (dB) 96 ± 2 at 100mV
 Frequency Range (Hz) 200-4000
 THD $< 2\%$
 Operating Temperature ($^{\circ}\text{C}$) -10-+40
 Weight (g) 8

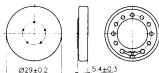
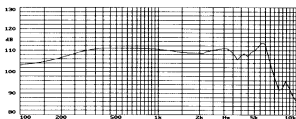

Type **SD-22**
 DC Resistance (Ω) 135 ± 15
 AC Impedance (Ω) 150 ± 30
 Sensitivity (dB) 98 ± 2 at 60mV
 Frequency Range (Hz) 200-4000
 THD $< 5\%$
 Operating Temperature ($^{\circ}\text{C}$) -20-+40
 Weight (g) 30

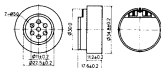
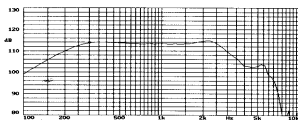

Type **SD-23**
 DC Resistance (Ω) $55 \pm 10\%$
 AC Impedance (Ω) $60 \pm 20\%$
 Sensitivity (dB) 110 ± 3 at 1mW
 Frequency Range (Hz) 300-3200
 THD $< 5\%$
 Operating Temperature ($^{\circ}\text{C}$) -25-+60
 Weight (g) 5

