

EVD CORE



TYPE	FIG.	Dimensions(mm)					
		A	B	C	D	E	F
EVD15	1	14.8 +0.7/-0.5	9.0 +0/-0.3	7.0 +0/-0.4	5.8 +0/-0.4	10.8 +0.6/-0	6.0 +0.4/-0
EVD25	2	25.0 +0.6/-0.3	13.0 +0/-0.4	12.7 +0/-0.5	8.8 ±0.25	19.2 +0.9/-0	9.45 +0.5/-0
EVD30	3	29.7 ±0.8	16.4 ±0.3	12.5 ±0.4	11.6 ±0.3	22.1 ±0.5	11.9 ±0.3

LP CORE



TYPE	FIG.	Dimensions(mm)					
		A	B	C	D	E	F
LP16.5/23/8.7	1	16.5 ±0.3	11.7 ±0.15	8.7 ±0.2	5.7 ±0.2	12.5 ±0.3	8.7 ±0.3
LP25/22/13	1	25.0 ±0.7	11.2 ±0.2	12.9 ±0.3	8.6 ±0.3	18.55min	8.2 ±0.2
LP25/32/13	1	25.0 ±0.7	15.9 ±0.2	12.9 ±0.3	8.6 ±0.3	18.55min	12.05 ±0.25

EVD CORE

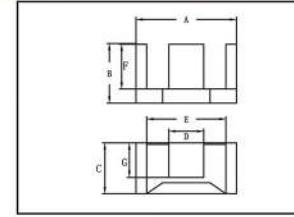

FIG.1

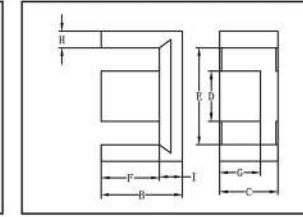

FIG.2

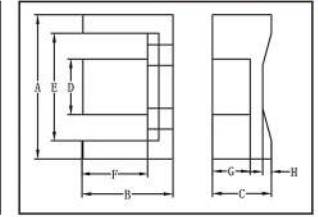

FIG.3

G	Cl (mm ³)	Ae (mm ²)	Le (mm)	Ve (mm ³)	AL ± 25% (nH/N ²)			Weight g/PRS
					FW40	FW44	FW95	
4.8 +0/-0.4	1.4	27.7	38.7	1070	1460	1510	1860	5.6
8.3 ±0.3	0.85	73.07	61.8	4515.7	2610	2700	3440	24.6
8.2 ±0.3	0.76	99	74.8	7410	3020	3130	4020	39

LP CORE

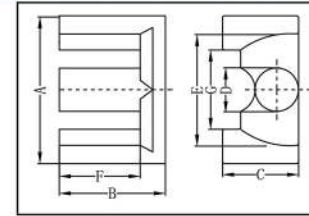

FIG.1

G	Cl (mm ³)	Ae (mm ²)	Le (mm)	Ve (mm ³)	AL ± 25% (nH/N ²)			Weight g/PRS
					FW40	FW44	FW95	
9.0 ±0.5	1.45	32.17	46.57	1498.3	1400	1210	1250	9.8
13.5 ±0.6	0.74	68.71	50.89	3496.7	2510	2590	3260	21
13.5 ±0.6	0.93	71.52	66.36	4746.3	2400	2400	2690	31.01