



Micro Commercial Components
 21201 Itasca Street Chatsworth
 CA 91311
 Phone: (818) 701-4933
 Fax: (818) 701-4939

RS1001 THRU RS1007

Features

- Low Leakage
- Low Forward Voltage
- Any Mounting Position
- Silver Plated Copper Leads

10 Amp Single Phase Bridge Rectifier 50 to 1000 Volts

Maximum Ratings

- Operating Temperature: -55°C to +150°C
- Storage Temperature: -55°C to +150°C

| Microsemi Catalog Number | Device Marking | Maximum Recurrent Peak Reverse Voltage | Maximum RMS Voltage | Maximum DC Blocking Voltage |
|--------------------------|----------------|--|---------------------|-----------------------------|
| RS1001 | RS1001 | 50V | 35V | 50V |
| RS1002 | RS1002 | 100V | 70V | 100V |
| RS1003 | RS1003 | 200V | 140V | 200V |
| RS1004 | RS1004 | 400V | 280V | 400V |
| RS1005 | RS1005 | 600V | 420V | 600V |
| RS1006 | RS1006 | 800V | 560V | 800V |
| RS1007 | RS1007 | 1000V | 700V | 1000V |

Electrical Characteristics @ 25°C Unless Otherwise Specified

| | | | |
|---|-------------|---------------------------|---|
| Average Forward Current | $I_{F(AV)}$ | 10 A | $T_J = 65^\circ\text{C}$ |
| Peak Forward Surge Current | I_{FSM} | 300A | 8.3ms, half sine |
| Maximum Forward Voltage Drop Per Element | V_F | 1.1V | $I_{FM} = 5.0\text{A}; T_J = 25^\circ\text{C}^*$ |
| Maximum DC Reverse Current At Rated DC Blocking Voltage | I_R | 10 μA 100mA | $T_J = 25^\circ\text{C}$ $T_J = 100^\circ\text{C}$ |

*Pulse test: Pulse width 300 μsec , Duty cycle 1%

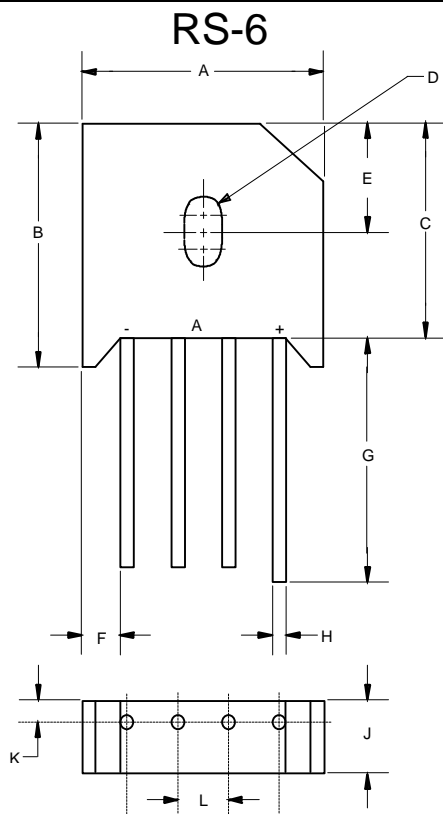

| DIM | INCHES | | MM | | NOTE |
|-----|--------------------------|------|---------------------------|-------|------|
| | MIN | MAX | MIN | MAX | |
| A | --- | .925 | --- | 23.50 | |
| B | --- | .763 | --- | 19.40 | |
| C | --- | .680 | --- | 17.20 | NOM |
| D | .15 \varnothing x .23L | | 3.8 \varnothing x 5.57L | | HOLE |
| E | --- | .300 | --- | 7.50 | NOM |
| F | --- | .157 | --- | 4.00 | NOM |
| G | 1.00 | --- | 25.40 | --- | |
| H | --- | .050 | --- | 1.30 | TYP |
| J | --- | .280 | --- | 7.00 | |
| K | --- | .075 | --- | 1.90 | NOM |
| L | --- | .200 | --- | 5.10 | 3PL |

RS1001 thru RS1007

Figure 1
Typical Forward Characteristics

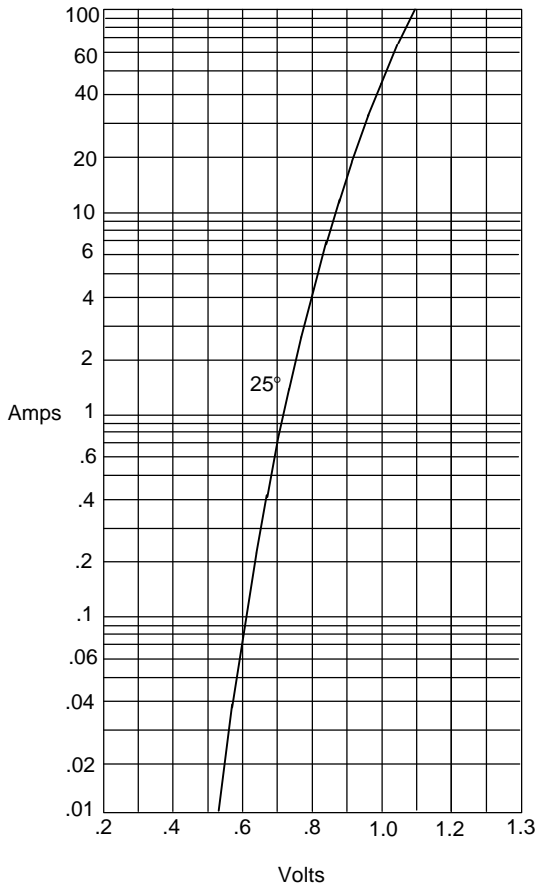

Instantaneous Forward Current - Amperes versus
Instantaneous Forward Voltage - Volts

Figure 2
Typical Reverse Characteristics

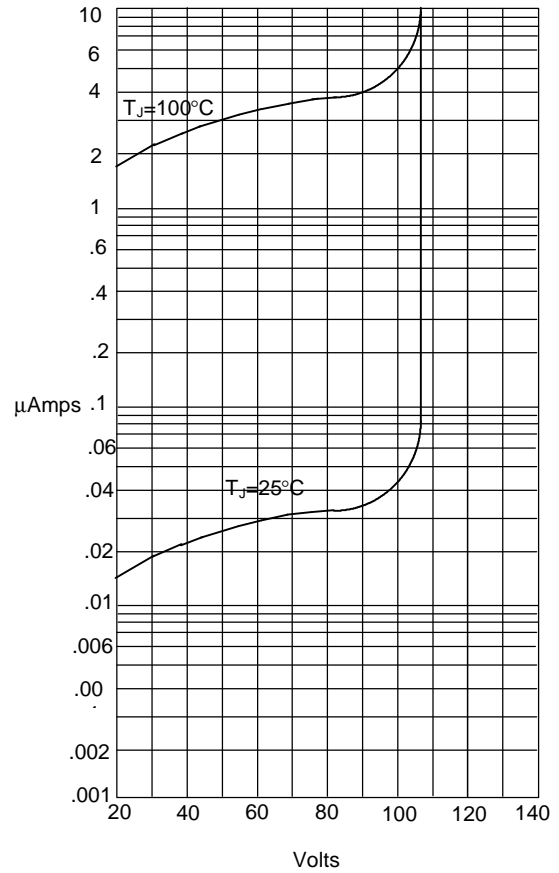

Instantaneous Reverse Leakage Current - MicroAmperes versus
Percent Of Rated Peak Reverse Voltage - Volts

Figure 3
Forward Derating Curve

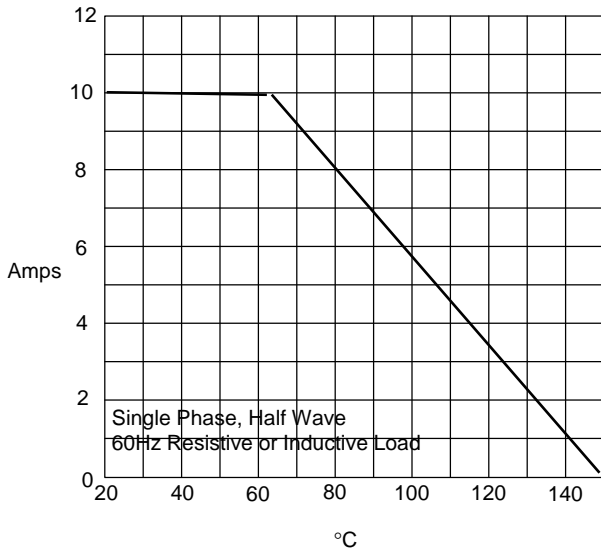

Average Forward Rectified Current - Amperes versus
Ambient Temperature - °C

Figure 4
Peak Forward Surge Current

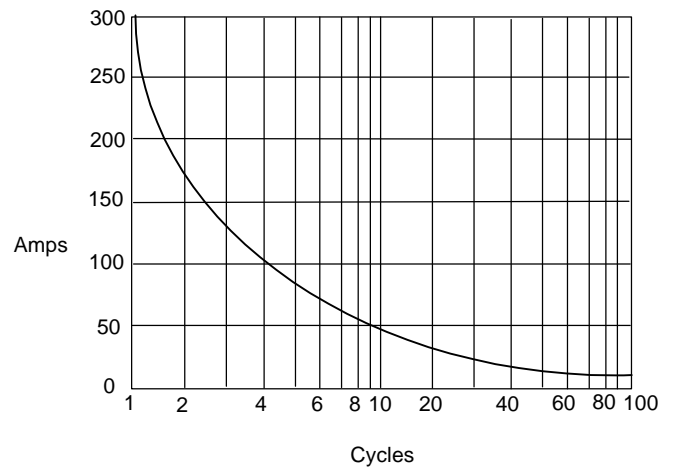

Peak Forward Surge Current - Amperes versus
Number Of Cycles At 60Hz - Cycles

This datasheet has been download from:

www.datasheetcatalog.com

Datasheets for electronics components.