

1 2 3 4 5 6 7 8

A

A

B

B

C

C

D

D

E

E

F

F

FEATURES

- * Screw mount or self adhesive
- * Center leads with 22# 450±20mmUA length
- * Longer leads on request
- * Spacer available
- * 2 Conductor jacket cable on request
- * Switches or magnets available seperately
- * Colors: White ,Brown,Grey

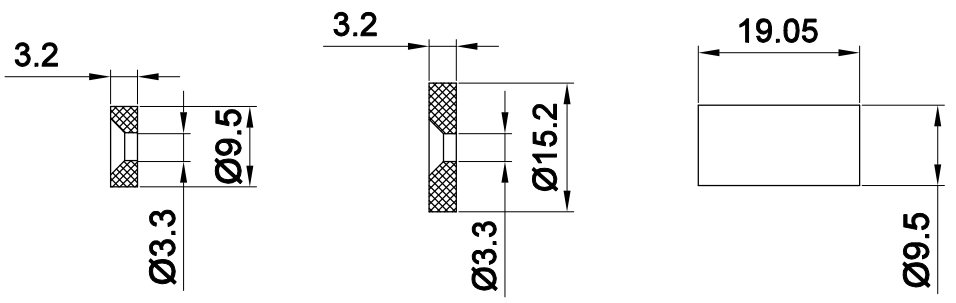
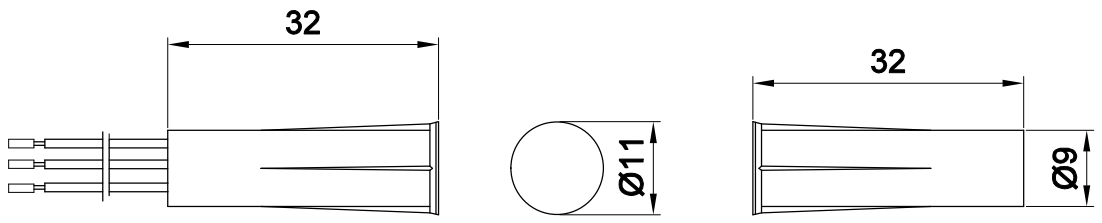

SPECIFICATION

1. Loop Type.....Closed&Open
2. Wires ConnectionBLACK=COMMON
RED=OPEN LOOP
WHITE=CLOSED LOOP
3. Reed From.....SPDT
4. Gap[Inch(mm)]..... 5/8(15)
5. Maximum Initial Contact Resistance(Ohm).....0.15
6. Maximum Contact Rating(W).....3
7. Maximum Switching Voltage(VDC/VAC).....30
8. Maximum Switching Current(A).....0.2

				KEPO NINGBO KEPO ELECTRONIC CO.,LTD http://www.chinaacoustic.com	
No.	DESCRIPTION	APPROVED	DATE	Magnetic Contact Switches KP-1301MD-R COM	
TOLERANCES UNLESS NOTED OTHERWISE X ± XX ± XXX ± 90° FORMED ±0.2° ANGLES ±1°		APPROVALS	DATE		
FIRST ANGLE PROJECTION		DRAWN		UNIT	DWG NO.
		CHECKED		mm	KP2.840.037.01
		APPROVED	16.7.12	SCALE	SHEET
				NOT TO SCALE	VER 1.0

1 2 3 4 5 6 7 8