

Circuit	Dimensions(mm)	
	A	B
02	2.50	7.50
03	5.00	10.00
04	7.50	12.50
05	10.00	15.00
06	12.50	17.50
07	15.00	20.00
08	17.50	22.50
09	20.00	25.00
10	22.50	27.50
11	25.00	30.00
12	27.50	32.50
13	30.00	35.00
14	32.50	37.50
15	35.00	40.00
16	37.50	42.50
17	40.00	45.00
18	42.50	47.50
19	45.00	50.00
20	47.50	52.50

**Material:**  
Housing:PA66(UL94V-0),White  
Contacts:Brass Tin

**Electrical Characteristics:**  
1.Poles: 2 to 20P  
2.Current rating: 3.0A  
3.Voltage rating: 250V  
4.Temperature range: -25°C to +85°C  
5.Contact resistance: ≤10mΩ  
6.Insulation resistance: ≥1000MΩ  
7.Withstand voltage: 1000V AC/minute  
8.Applicable wire: AWG #30 to #22  
9.Applicable PC board thickness: 1.6mm

**Order Information**  
L-KLS1-2.50-XX-R1

- Type:R1=Right Male pin
- PIN Number: 02~20Pin
- Pitch: 2.50=2.50mm
- Series No.
- RoHS

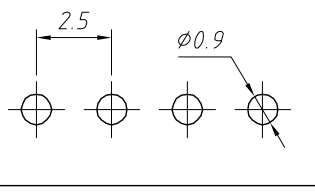

PCB LAYOUT

GENERAL TOLERANCE	PROJECTION		Description:
X. ±0.50	UNITS	mm	2.50mm Pitch XH Type Wire To Board Connector
.X ±0.25	SCALE	1:1	
.XX ±0.10	Draw by:	Jenny	
ANGLE TOLERANCE	Check by:		KLS P/N: L-KLS1-2.50-XX-R1
X. ±5°	Date	2018-03-01	NingBo KLS ELECTRONIC CO.,L TD.
.X ±3°	SHEET	1 OF 1	
.XX ±2°			