

1 RoHS Compliance

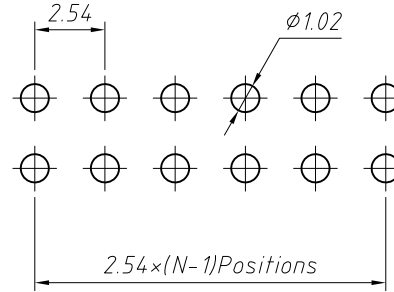
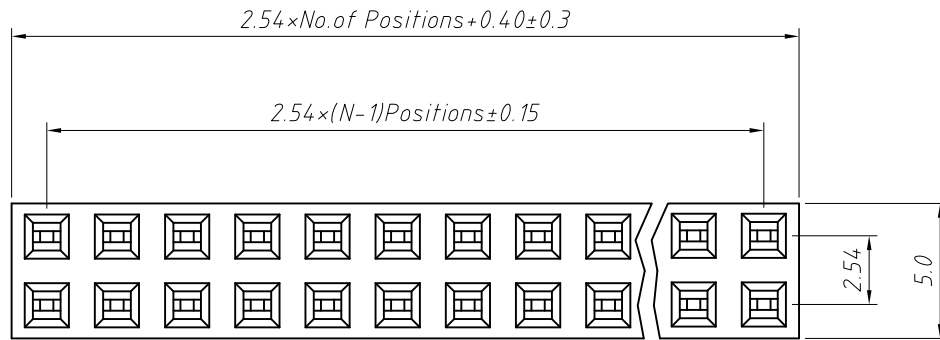

Recommended PCB Hole Layout

**Material:**  
 Standard: PBT/PA6T  
 Contact: Brass  
 Contact plating: Gold Flash all over  
 Nickel Insulator: Polyester, UL 94 V-0

**Electrical Characteristics:**  
 Rated Current: 3.0AMP  
 Contact Resistance: 20mΩ Max  
 Withstand Voltage: 1000V AC/DC  
 Insulator Resistance: 1000MΩ Min

**Mechanical**  
 Operating Temperature: -40°C ~ +105°C  
 Max. Processing Temp: 180°C for 30-60 seconds (200°C for 10 seconds)

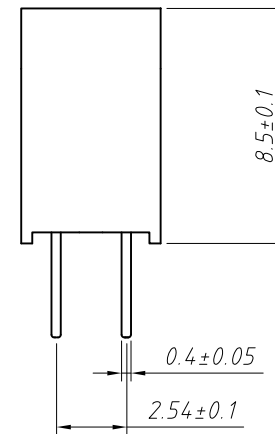
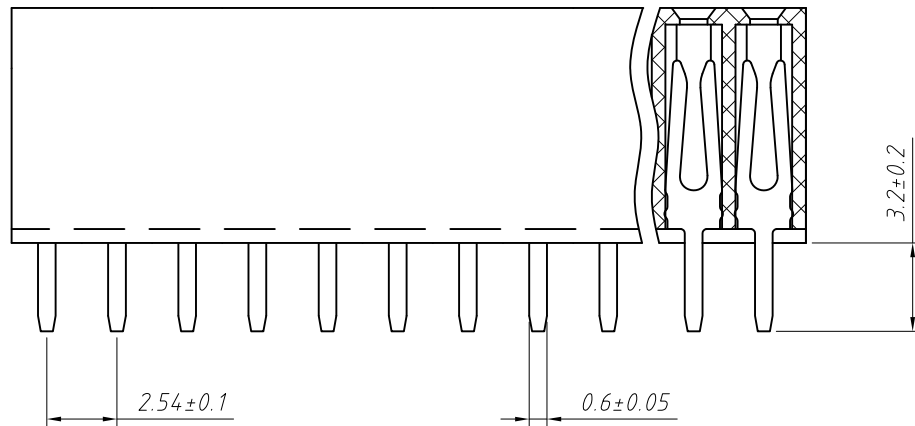

**Order Information:**

L-KLS1-208-2-XX-S-B

L: RoHS  
 Pin Header Series  
 208: 2.54mm  
 Per Row: Double layer  
 Pin: No. of Pins (2x40)  
 Type: Straight Pin  
 Material: A=PBT B=PA6T C=LCP

ANGLE TOLERANCE	PROJECTION	Description:
±3°		2.54x8.5mm Female Header Double layer, Straight Pin, 2xN Pin
GENERAL TOLERANCE	UNITS	mm
x.x ±0.30	SHEET SIZE	A4
x.xx ±0.20	Draw:	Daniel 2018-07-10
x.xxx ±0.10	Check:	Daniel 2018-07-10



NingBo KLS ELECTRONIC CO.,L TD.