

Available in sizes of 6 to 48 pins.

Low profile & dual-beam contact design.

Contact design incorporates anti-overstress feature.

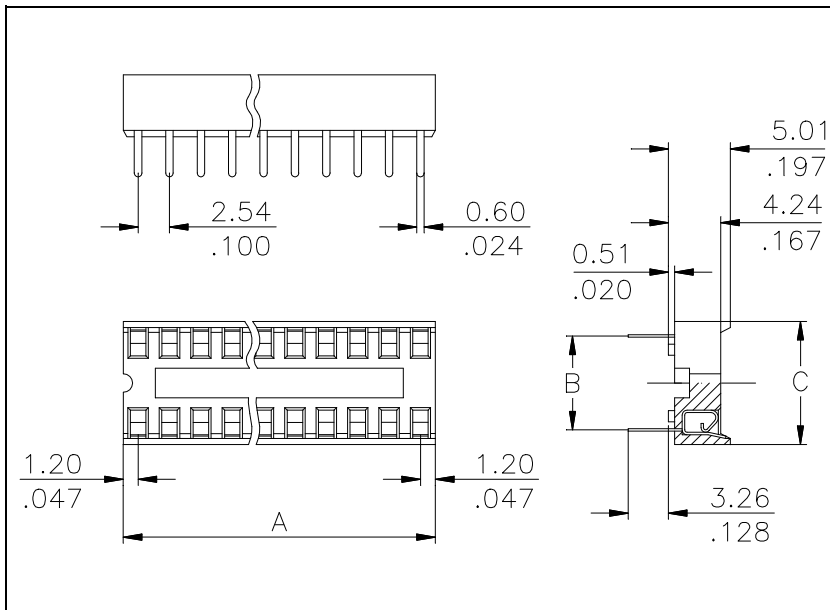
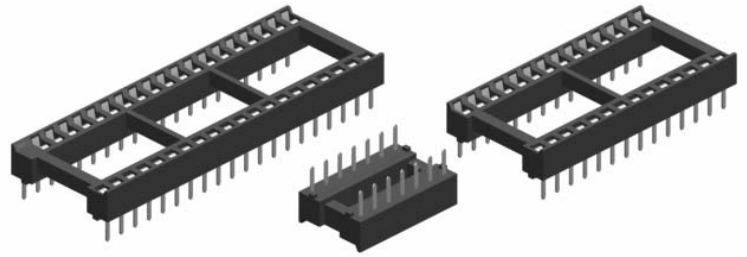

Pin	Dimensions mm/inch			Ordering Code
	"A"	"B"	"C"	
6	7,49/.295	7,62 / .300	10,16 / .400	LOC-306-T051-99
8	10,03/.795			LOC-308-T051-99
14	17,65/.695			LOC-314-T051-99
16	20,19/.795			LOC-316-T051-99
18	22,73/.895			LOC-318-T051-99
20	25,27/.995			LOC-320-T051-99
24	30,35/1.195			LOC-324-T051-99
28	35,43/1.395			LOC-328-T051-99
22	27,81/1.095	10,16 / .400	12,70 / .500	LOC-422-T051-99
24	30,35/1.195	15,24 / .600	17,70 / .700	LOC-624-T051-99
28	35,43/1.395			LOC-628-T051-99
32	40,51/1.595			LOC-632-T051-99
40	50,67/1.995			LOC-640-T051-99
42	53,21/2.095			LOC-642-T051-99
48	60,83/2.395			LOC-648-T051-99

Low Cost DIP are also available with the "Shrink" pitch 1,778mm / .070".
Please request separate datasheets.

Specification

Mechanical data

Insertion force 2 N max.
Extraction force 0,5 N min.
Contact reliability 50 cycles min

Material

Insulator (RoHS compliant) std. temp PBT plastic
UL 94 V-0
Contact (RoHS compliant) Phosphor bronze

Electrical data

Contact resistance 10 mΩ typ.
Current rating 1A max., 100V
Contact capacitance 0,5 pF
Insulation resistance 1000 MΩ min.
Breakdown voltage 1 KV min.

Operating temperature

-50°C to +125°C

How to order

LOC - x xx - T051 - 99

