

## The explanations of the digits are shown below

### KEY PRODUCT CODES

The products codes are expressed by a 10-digit number as shown in the example below. The explanations of the digits are shown below.

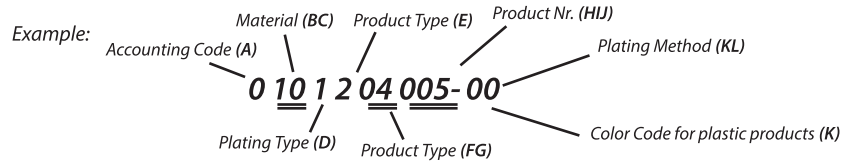

### EXPLANATIONS

**A- Accounting Department Code:** Code for our accounting department.

#### BC- Material:

- 10- Brass (CuZn30)
- 11- Brass (CuZn36)
- 12- Brass (CuZn37)
- 20- Copper (E-Cu)
- 21- CuNiSi
- 22- CuFe
- 25- German Silver (CuNiZn)
- 30- Phospor Bronze (CuSn6)
- 31- Phospor Bronze (CuSn4)
- 32- Phospor Bronze+Stainless Steel (CuSn4+X10CrNi)
- 33- Phospor Bronze+Stainless Steel (CuSn6+X10CrNi)
- 34- CuSn0,1
- 41- Stainless Steel (X5CrNi)
- 50- DC
- 70- Plastic (PA6.6)-Flammability Class V2
- 72- Plastik (PVC)
- 73- Plastik (PE-I 20)
- 78- Plastic (PA6)-Flammability Class V2 V2-NF
- 79- PBT
- 83- PA6.6 (GF) %20
- 84- PA6.6 (GF) %13
- 90- PA6.6 (GF) %50
- 93- PPS (GF) %65

#### FG- Product Type:

- 01- Faston Type Tabs
- 02- Tubular Type Plug Terminals
- 03- Special Faston Tabs
- 04- Faston Type Terminals
- 05- Tubular Type Sockets
- 06- Special Type Terminals
- 07- Ring Terminal
- 08- Spade Tongue Terminal
- 09- Ring Tongue Terminal
- 10- End Splices
- 11- Splices with Insulation Barrel
- 12- Hat-Mate
- 40- Terminal Housing (Male)
- 41- Terminal Housing (Female)
- 42- Terminal Sleeves
- 43- Sleeved Faston Tabs
- 44- PCB Connector
- 80- Other Product

#### D- Plating Type:

- 0-Unplated
- 1- Tin Plated Bright
- 2- Nickel Plated
- 3- Silver Plated
- 4- Copper+Nickel Plated
- 5- Copper Plated
- 6- Tin Plated Matte
- 7- Other
- 8- Nickel+Tin Plated Bright
- 9- Nickel+Tin Plated Matte

#### KL- Plating Method:

- 00- Pre-Tin

#### K- Color Code (For Plastics)

- 0- Natural
- 1- White
- 2- Black
- 3- Red
- 4- Yellow
- 5- Green
- 6- Blue
- 7- Grey
- 8- Brown
- 9- Purple
- 10- Orange
- 11- Copper Tone

#### E- Product Type:

- 1- Reel
- 2- Single
- 3- Semi-finished Product
- 4- Reverse Winding

#### HIJ Product Number:

- 001
- 002
- 003
- ....
- ....

### KEY TO TERMINAL DESCRIPTION

Terminals are described as shown in the example below. The explanations of the digits are shown below.

Example: For 6.3 Faston type receptacles:

#### Explanations:

(A) - Nominal value for female terminals

NOMINAL VALUE FOR FEMALE TERMINALS			
CODE	NOM.	MALE	FEMALE
(A)	0.50	0.50	0.40
(B)	0.80	0.80	0.70
(C)	0.55	0.80	0.55
(D)	0.30	0.40	0.30
(E)	0.60	0.80	0.60
(F)	0.70	0.80	0.70
(G)	0.75	0.85	0.75
(H)	0.65	0.80	0.65
(S)	0.80	0.85	0.80
(N)	0.25	0.50	0.25
(P)	0.50	0.50	0.50
(J)	0.90	1.0	0.90

(6.3) - The value in paranthesis is; Tab width for faston terminals (mm)  
Nominal value for faston type receptacles (mm)



**D- Product Type:** D-Single R-Reel Y-Semi-finished Product

**P- Material:** P-Brass B-Copper M-Stainless-finished Product  
F- Phosphor Bronze C-DC A-German Silver D-CuFe

**K- Plating Type:** K- Tin Plated N-Nickel Plated  
G-Silver Plated Z-Zinc Plated B-Copper Plated

## Faston Female Terminals

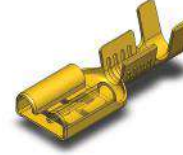
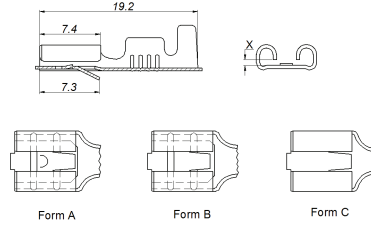

6.3 mm

Ürün Adı Product Name	Ürün Kodu Product Code	Malzeme Kalınlığı (mm) Material Thickness (mm)	Kablo Kesiti (mm <sup>2</sup> ) Wire Size (mm <sup>2</sup> )	Form	X	TAB	Malzeme / Material			Adet / SPQ	
							CuZn	CuSn	DC	Rulo / Chain	Dökme / Loose
SF2DK (6.3)	0XXXX04024	0,35	0,50-1,00	A	0,65	0,80	●	●	-	5.000	6.000
SF2DK (F) (6.3)	0XXXX04186	0,35	0,50-1,00	A	0,70	0,80	●	●	-	5.000	6.000
SF2DK (B) (6.3)	0XXXX04274	0,35	0,50-1,00	A	0,70	0,80	●	●	-	5.000	6.000
SF2DK NKTZ (6.3)	0XXXX04442	0,35	0,50-1,00	B	0,65	0,80	●	●	-	5.000	6.000
SF2DK (B) NKTZ (6.3)	0XXXX04284	0,35	0,50-1,00	B	0,70	0,80	●	●	-	5.000	6.000
SF2DM (6.3)	0XXXX04433	0,35	0,80-2,00	A	0,65	0,80	●	●	-	5.000	6.000
SF2DM NKTZ (6.3)	0XXXX04431	0,35	0,80-2,00	B	0,65	0,80	●	●	-	5.000	6.000
SF2D (6.3)	0XXXX04022	0,35	1,00-2,50	A	0,65	0,80	●	●	-	5.000	6.000
SF2D (G) (6.3)	0XXXX04223	0,35	1,00-2,50	A	0,75	0,85	●	●	-	5.000	6.000
SF2D NKTZ (6.3)	0XXXX04443	0,35	1,00-2,50	B	0,65	0,80	●	●	-	5.000	6.000
SF2D (B) NKTZ (6.3)	0XXXX04160	0,35	1,00-2,50	B	0,70	0,80	●	●	-	5.000	6.000
SF2D (E) NKTZ (6.3)	0XXXX04257	0,35	1,00-2,50	B	0,60	0,80	●	●	-	5.000	6.000
SF2D (G) NKTZ (6.3)	0XXXX04275	0,35	1,00-2,50	B	0,75	0,85	●	●	-	5.000	6.000
SF2DK-L (6.3)	0XXXX04111	0,35	0,50-1,00	C	0,60	0,80	●	-	-	5.000	6.000
SF2D-L (6.3)	0XXXX04114	0,35	1,00-2,50	C	0,60	0,80	●	-	-	5.000	6.000
SF2DBK (6.3)	0XXXX04230	0,40	2,50-4,00	A	0,60	0,80	●	●	-	4.000	5.000
SF2DB (6.3)	0XXXX04023	0,40	4,00-6,00	A	0,65	0,80	●	●	-	4.000	5.000
SF2DB (B) (6.3)	0XXXX04183	0,40	4,00-6,00	A	0,70	0,80	●	●	-	4.000	5.000
SF2DB (G) (6.3)	0XXXX04247	0,40	4,00-6,00	A	0,75	0,85	●	●	-	4.000	5.000
SF2DB NKTZ (6.3)	0XXXX04444	0,40	4,00-6,00	B	0,65	0,80	●	●	-	4.000	5.000
SF2DB-L (6.3)	0XXXX04262	0,40	4,00-6,00	C	0,65	0,80	●	-	-	4.000	5.000

Kullanıldığı Konnektörler / Used with insulation housing	Sayfa / Page
101 Erkek Konnektör (1 Gözlü) / 101 Male Housing (1 Pole)	0XXXX40001-0 13-1
201 Erkek Konnektör (2 Gözlü) / 201 Male Housing (2 Poles)	0XXXX40002-0 13-1
201-T Erkek Konnektör (2 Gözlü) / 201-T Male Housing (2 Poles)	8XXXX40038-0 13-2
301 Erkek Konnektör (3 Gözlü) / 301 Male Housing (3 Poles)	0XXXX40003-0 13-2
401 Erkek Konnektör (4 Gözlü) / 401 Male Housing (4 Poles)	8XXXX40004-0 13-3
601 Erkek Konnektör (6 Gözlü) / 601 Male Housing (6 Poles)	0XXXX40005-0 13-3
601B Erkek Konnektör (6 Gözlü) / 601B Male Housing (6 Poles)	0XXXX40006-0 13-3
801 Erkek Konnektör (8 Gözlü) / 801 Male Housing (8 Poles)	8XXXX40007-0 13-4

Kaplama / Plating		
Sn	Ni	Ag
✓	✓	✓

- Standard Part
- \* Available on request