

## The explanations of the digits are shown below

### KEY PRODUCT CODES

The products codes are expressed by a 10-digit number as shown in the example below. The explanations of the digits are shown below.

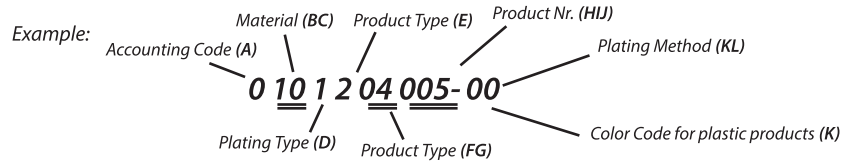

### EXPLANATIONS

**A- Accounting Department Code:** Code for our accounting department.

#### BC- Material:

- 10- Brass (CuZn30)
- 11- Brass (CuZn36)
- 12- Brass (CuZn37)
- 20- Copper (E-Cu)
- 21- CuNiSi
- 22- CuFe
- 25- German Silver (CuNiZn)
- 30- Phospor Bronze (CuSn6)
- 31- Phospor Bronze (CuSn4)
- 32- Phospor Bronze+Stainless Steel (CuSn4+X10CrNi)
- 33- Phospor Bronze+Stainless Steel (CuSn6+X10CrNi)
- 34- CuSn0,1
- 41- Stainless Steel (X5CrNi)
- 50- DC
- 70- Plastic (PA6.6)-Flammability Class V2
- 72- Plastik (PVC)
- 73- Plastik (PE-I 20)
- 78- Plastic (PA6)-Flammability Class V2 V2-NF
- 79- PBT
- 83- PA6.6 (GF) %20
- 84- PA6.6 (GF) %13
- 90- PA6.6 (GF) %50
- 93- PPS (GF) %65

#### FG- Product Type:

- 01- Faston Type Tabs
- 02- Tubular Type Plug Terminals
- 03- Special Faston Tabs
- 04- Faston Type Terminals
- 05- Tubular Type Sockets
- 06- Special Type Terminals
- 07- Ring Terminal
- 08- Spade Tongue Terminal
- 09- Ring Tongue Terminal
- 10- End Splices
- 11- Splices with Insulation Barrel
- 12- Hat-Mate
- 40- Terminal Housing (Male)
- 41- Terminal Housing (Female)
- 42- Terminal Sleeves
- 43- Sleeved Faston Tabs
- 44- PCB Connector
- 80- Other Product

#### D- Plating Type:

- 0-Unplated
- 1- Tin Plated Bright
- 2- Nickel Plated
- 3- Silver Plated
- 4- Copper+Nickel Plated
- 5- Copper Plated
- 6- Tin Plated Matte
- 7- Other
- 8- Nickel+Tin Plated Bright
- 9- Nickel+Tin Plated Matte

#### KL- Plating Method:

- 00- Pre-Tin

#### K- Color Code (For Plastics)

- 0- Natural
- 1- White
- 2- Black
- 3- Red
- 4- Yellow
- 5- Green
- 6- Blue
- 7- Grey
- 8- Brown
- 9- Purple
- 10- Orange
- 11- Copper Tone

#### E- Product Type:

- 1- Reel
- 2- Single
- 3- Semi-finished Product
- 4- Reverse Winding

#### HIJ Product Number:

- 001
- 002
- 003
- ....
- ....

### KEY TO TERMINAL DESCRIPTION

Terminals are described as shown in the example below. The explanations of the digits are shown below.

Example: For 6.3 Faston type receptacles:

#### Explanations:

(A) - Nominal value for female terminals

| NOMINAL VALUE FOR FEMALE TERMINALS |      |      |        |
|------------------------------------|------|------|--------|
| CODE                               | NOM. | MALE | FEMALE |
| (A)                                | 0.50 | 0.50 | 0.40   |
| (B)                                | 0.80 | 0.80 | 0.70   |
| (C)                                | 0.55 | 0.80 | 0.55   |
| (D)                                | 0.30 | 0.40 | 0.30   |
| (E)                                | 0.60 | 0.80 | 0.60   |
| (F)                                | 0.70 | 0.80 | 0.70   |
| (G)                                | 0.75 | 0.85 | 0.75   |
| (H)                                | 0.65 | 0.80 | 0.65   |
| (S)                                | 0.80 | 0.85 | 0.80   |
| (N)                                | 0.25 | 0.50 | 0.25   |
| (P)                                | 0.50 | 0.50 | 0.50   |
| (J)                                | 0.90 | 1.0  | 0.90   |

(6.3) - The value in paranthesis is; Tab width for faston terminals (mm)  
Nominal value for faston type receptacles (mm)

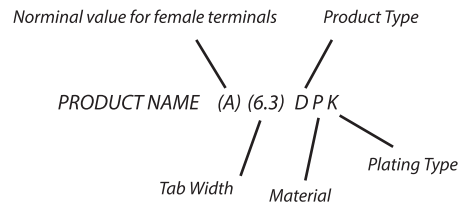

**D- Product Type:** D-Single R-Reel Y-Semi-finished Product

**P- Material:** P-Brass B-Copper M-Stainless-finished Product  
F- Phosphor Bronze C-DC A-German Silver D-CuFe

**K- Plating Type:** K- Tin Plated N-Nickel Plated  
G-Silver Plated Z-Zinc Plated B-Copper Plated

Faston Female Terminals

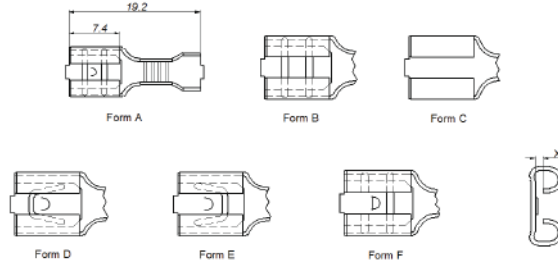

6.3 mm

| Ürün Adı<br>Product Name | Ürün Kodu<br>Product Code | Malzeme Kalınlığı (mm)<br>Material Thickness (mm) | Kablo Kesiti (mm <sup>2</sup> )<br>Wire Size (mm <sup>2</sup> ) | Form | X    | TAB  | Malzeme / Material |      |    | Adet / SPQ   |               |
|--------------------------|---------------------------|---|---|------|------|------|--------------------|------|----|--------------|---------------|
|                          |                           |   |   |      |      |      | CuZn               | CuSn | DC | Rulo / Chain | Dökme / Loose |
| SF1DKM (6.3)             | 0XXXX04182                | 0,40  | 0,25-0,50   | A    | 0,60 | 0,80 | ●                  | ●    | ●  | 6.000        | 6.000         |
| SF1DK (6.3)              | 0XXXX04009                | 0,40  | 0,50-1,00   | A    | 0,60 | 0,80 | ●                  | ●    | ●  | 6.000        | 6.000         |
| SF1DK (F) (6.3)          | 0XXXX04248                | 0,40  | 0,50-1,00   | A    | 0,70 | 0,80 | ●                  | ●    | *  | 6.000        | 6.000         |
| SF1DK (G) (6.3)          | 0XXXX04152                | 0,40  | 0,50-1,00   | A    | 0,75 | 0,85 | ●                  | ●    | *  | 6.000        | 6.000         |
| SF1DK NKTZ (6.3)         | 0XXXX04286                | 0,40  | 0,50-1,00   | B    | 0,60 | 0,80 | ●                  | ●    | *  | 6.000        | 6.000         |
| SF1DM (6.3)              | 0XXXX04434                | 0,40  | 0,80-2,00   | A    | 0,60 | 0,80 | ●                  | ●    | ●  | 6.000        | 6.000         |
| SF1D (6.3)               | 0XXXX04006                | 0,40  | 1,00-2,50   | A    | 0,60 | 0,80 | ●                  | ●    | ●  | 6.000        | 6.000         |
| SF1D (B) (6.3)           | 0XXXX04181                | 0,40  | 1,00-2,50   | A    | 0,70 | 0,80 | ●                  | ●    | *  | 6.000        | 6.000         |
| SF1D (G) (6.3)           | 0XXXX04222                | 0,40  | 1,00-2,50   | A    | 0,75 | 0,85 | ●                  | ●    | *  | 6.000        | 6.000         |
| SF1DK-L (6.3)            | 0XXXX04113                | 0,35  | 0,50-1,00   | C    | 0,60 | 0,80 | ●                  | -    | -  | 6.000        | 6.000         |
| SF1D-L (6.3)             | 0XXXX04090                | 0,35  | 1,00-2,50   | C    | 0,60 | 0,80 | ●                  | -    | -  | 6.000        | 6.000         |
| SF1DK-U1 (6.3)           | 0XXXX04067                | 0,40  | 0,50-1,00   | D    | 0,70 | 0,80 | ●                  | *    | *  | 6.000        | 6.000         |
| SF1D-U1 (6.3)            | 0XXXX04068                | 0,40  | 1,00-2,50   | D    | 0,70 | 0,80 | ●                  | *    | *  | 6.000        | 6.000         |
| SF1DB-U1 (6.3)           | 0XXXX04066                | 0,40  | 4,00-6,00   | D    | 0,70 | 0,80 | ●                  | *    | *  | 6.000        | 6.000         |
| SF1DK-U (6.3)            | 0XXXX04063                | 0,40  | 0,50-1,00   | E    | 0,70 | 0,80 | ●                  | *    | *  | 6.000        | 6.000         |
| SF1D-U (6.3)             | 0XXXX04056                | 0,40  | 1,00-2,50   | E    | 0,70 | 0,80 | ●                  | *    | *  | 6.000        | 6.000         |
| SF1DB-U (6.3)            | 0XXXX04065                | 0,40  | 4,00-6,00   | E    | 0,70 | 0,80 | ●                  | *    | *  | 6.000        | 6.000         |
| SF35DK (6.3)             | 0XXXX04405                | 0,45  | 0,50-1,00   | F    | 0,55 | 0,80 | ●                  | *    | *  | 6.000        | 6.000         |
| SF35D (6.3)              | 0XXXX04404                | 0,45  | 1,00-2,50   | F    | 0,55 | 0,80 | ●                  | *    | *  | 6.000        | 6.000         |
| SF1DBK (6.3)             | 0XXXX04228                | 0,40  | 2,50-4,00   | A    | 0,60 | 0,80 | ●                  | ●    | ●  | 5.000        | 5.000         |
| SF1DB (6.3)              | 0XXXX04010                | 0,40  | 4,00-6,00   | A    | 0,60 | 0,80 | ●                  | ●    | ●  | 5.000        | 5.000         |

| Kullanıldığı Konnektörler / Used with insulation housing | Sayfa / Page      |
|--|-------------------|
| 6.3 R2 Tipi Konnektör / 6.3 R2 Type Housing              | 0XXXX41025-0 13-6 |
| 6.3 TS 4'lü Konnektör / 6.3 TS 4 Housing (4 Poles)       | 0XXXX41015-0 13-7 |
| SF1D Kılıf (PE-I 20) / SF1D Sleeve                       | 0XXXX42002-0 14-1 |
| SF1D Kılıf (PA66) / SF1D Sleeve                          | 0XXXX42016-0 14-1 |
| SF1D Kılıf (PVC) / SF1D Sleeve                           | 0XXXX42017-0 14-1 |
| SF1D Yassı Kılıf (PVC) / SF1D Wide Sleeve                | 0XXXX42003-0 14-2 |

| Kaplama / Plating |    |    |
|-------------------|----|----|
| Sn                | Ni | Ag |
| ✓                 | ✓  | ✓  |

● / Standard Part  
\* Available on request

Faston Female Terminals

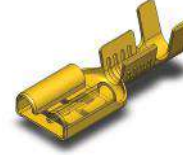
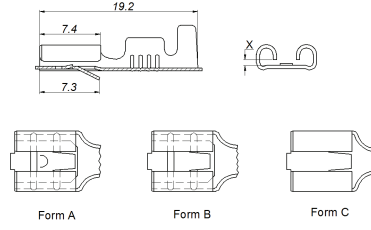

6.3 mm

| Ürün Adı<br>Product Name | Ürün Kodu<br>Product Code | Malzeme Kalınlığı (mm)<br>Material Thickness (mm) | Kablo Kesiti (mm <sup>2</sup> )<br>Wire Size (mm <sup>2</sup> ) | Form | X    | TAB  | Malzeme / Material |      |    | Adet / SPQ   |               |
|--------------------------|---------------------------|---|---|------|------|------|--------------------|------|----|--------------|---------------|
|                          |                           |   |   |      |      |      | CuZn               | CuSn | DC | Rulo / Chain | Dökme / Loose |
| SF2DK (6.3)              | 0XXXX04024                | 0,35  | 0,50-1,00   | A    | 0,65 | 0,80 | ●                  | ●    | -  | 5.000        | 6.000         |
| SF2DK (F) (6.3)          | 0XXXX04186                | 0,35  | 0,50-1,00   | A    | 0,70 | 0,80 | ●                  | ●    | -  | 5.000        | 6.000         |
| SF2DK (B) (6.3)          | 0XXXX04274                | 0,35  | 0,50-1,00   | A    | 0,70 | 0,80 | ●                  | ●    | -  | 5.000        | 6.000         |
| SF2DK NKTZ (6.3)         | 0XXXX04442                | 0,35  | 0,50-1,00   | B    | 0,65 | 0,80 | ●                  | ●    | -  | 5.000        | 6.000         |
| SF2DK (B) NKTZ (6.3)     | 0XXXX04284                | 0,35  | 0,50-1,00   | B    | 0,70 | 0,80 | ●                  | ●    | -  | 5.000        | 6.000         |
| SF2DM (6.3)              | 0XXXX04433                | 0,35  | 0,80-2,00   | A    | 0,65 | 0,80 | ●                  | ●    | -  | 5.000        | 6.000         |
| SF2DM NKTZ (6.3)         | 0XXXX04431                | 0,35  | 0,80-2,00   | B    | 0,65 | 0,80 | ●                  | ●    | -  | 5.000        | 6.000         |
| SF2D (6.3)               | 0XXXX04022                | 0,35  | 1,00-2,50   | A    | 0,65 | 0,80 | ●                  | ●    | -  | 5.000        | 6.000         |
| SF2D (G) (6.3)           | 0XXXX04223                | 0,35  | 1,00-2,50   | A    | 0,75 | 0,85 | ●                  | ●    | -  | 5.000        | 6.000         |
| SF2D NKTZ (6.3)          | 0XXXX04443                | 0,35  | 1,00-2,50   | B    | 0,65 | 0,80 | ●                  | ●    | -  | 5.000        | 6.000         |
| SF2D (B) NKTZ (6.3)      | 0XXXX04160                | 0,35  | 1,00-2,50   | B    | 0,70 | 0,80 | ●                  | ●    | -  | 5.000        | 6.000         |
| SF2D (E) NKTZ (6.3)      | 0XXXX04257                | 0,35  | 1,00-2,50   | B    | 0,60 | 0,80 | ●                  | ●    | -  | 5.000        | 6.000         |
| SF2D (G) NKTZ (6.3)      | 0XXXX04275                | 0,35  | 1,00-2,50   | B    | 0,75 | 0,85 | ●                  | ●    | -  | 5.000        | 6.000         |
| SF2DK-L (6.3)            | 0XXXX04111                | 0,35  | 0,50-1,00   | C    | 0,60 | 0,80 | ●                  | -    | -  | 5.000        | 6.000         |
| SF2D-L (6.3)             | 0XXXX04114                | 0,35  | 1,00-2,50   | C    | 0,60 | 0,80 | ●                  | -    | -  | 5.000        | 6.000         |
| SF2DBK (6.3)             | 0XXXX04230                | 0,40  | 2,50-4,00   | A    | 0,60 | 0,80 | ●                  | ●    | -  | 4.000        | 5.000         |
| SF2DB (6.3)              | 0XXXX04023                | 0,40  | 4,00-6,00   | A    | 0,65 | 0,80 | ●                  | ●    | -  | 4.000        | 5.000         |
| SF2DB (B) (6.3)          | 0XXXX04183                | 0,40  | 4,00-6,00   | A    | 0,70 | 0,80 | ●                  | ●    | -  | 4.000        | 5.000         |
| SF2DB (G) (6.3)          | 0XXXX04247                | 0,40  | 4,00-6,00   | A    | 0,75 | 0,85 | ●                  | ●    | -  | 4.000        | 5.000         |
| SF2DB NKTZ (6.3)         | 0XXXX04444                | 0,40  | 4,00-6,00   | B    | 0,65 | 0,80 | ●                  | ●    | -  | 4.000        | 5.000         |
| SF2DB-L (6.3)            | 0XXXX04262                | 0,40  | 4,00-6,00   | C    | 0,65 | 0,80 | ●                  | -    | -  | 4.000        | 5.000         |

| Kullanıldığı Konnektörler / Used with insulation housing       | Sayfa / Page      |
|--|-------------------|
| 101 Erkek Konnektör (1 Gözlü) / 101 Male Housing (1 Pole)      | 0XXXX40001-0 13-1 |
| 201 Erkek Konnektör (2 Gözlü) / 201 Male Housing (2 Poles)     | 0XXXX40002-0 13-1 |
| 201-T Erkek Konnektör (2 Gözlü) / 201-T Male Housing (2 Poles) | 8XXXX40038-0 13-2 |
| 301 Erkek Konnektör (3 Gözlü) / 301 Male Housing (3 Poles)     | 0XXXX40003-0 13-2 |
| 401 Erkek Konnektör (4 Gözlü) / 401 Male Housing (4 Poles)     | 8XXXX40004-0 13-3 |
| 601 Erkek Konnektör (6 Gözlü) / 601 Male Housing (6 Poles)     | 0XXXX40005-0 13-3 |
| 601B Erkek Konnektör (6 Gözlü) / 601B Male Housing (6 Poles)   | 0XXXX40006-0 13-3 |
| 801 Erkek Konnektör (8 Gözlü) / 801 Male Housing (8 Poles)     | 8XXXX40007-0 13-4 |

| Kaplama / Plating |    |    |
|-------------------|----|----|
| Sn                | Ni | Ag |
| ✓                 | ✓  | ✓  |

● / Standard Part

\* Available on request